

## AB 625 AMBIENT AIR CURTAIN

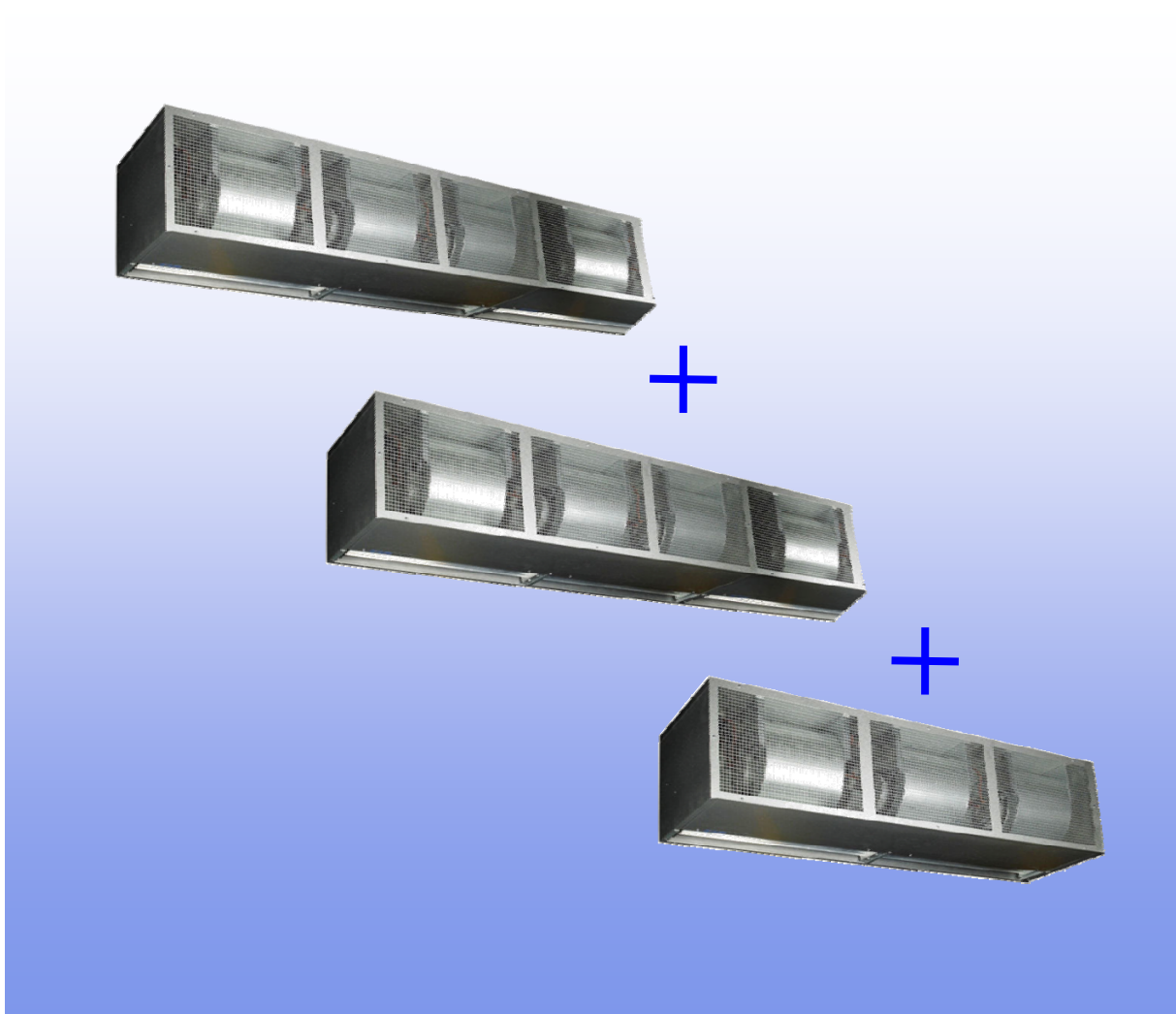

### WARNINGS

1. This appliance must only be installed, commissioned and serviced by competent persons in accordance with the requirements of the codes of practice or the rules in force.
2. All external wiring **MUST** comply with the current IEE wiring regulations.
3. This appliance **MUST** be earthed.

! These air curtains should be serviced annually by a competent person to ensure safe and efficient operation. In exceptionally dusty or polluted conditions more frequent servicing may be required. The manufacturer offers a maintenance service. Details available on request. **Isolate electricity supplies before commencing any work.**

The AB 625 air curtain consists of three modules made up as follows:  
2 off AB 225 four fan modules.  
1 off AB 175 three fan module.

#### Tools required.

The following tools and equipment are recommended to complete the tasks laid out in this bulletin. ! Suitable alternative tools may be used.



Cross point screwdriver



Small flat head screwdriver



13mm spanner



10mm spanner



Allen key set



Soft brush



Adjustable spanner

#### Air outlet louvres.

The air outlet louvres should be cleaned with a soft brush. Check that the louvres are set to the required angle. (See commissioning bulletin document reference **TB/040/0709** for setting procedure).

#### Air distribution fans.

The air distribution fans can be accessed by opening the fan access lids as described in section 7.1. of the instruction manual document reference **GB/AIR/039/0309**.

Clean off any dust or deposits with a soft brush paying particular attention to the impeller. Check that the impeller spins freely, and that there is no play in the fan bearings.

#### Electrical.

! **Isolate electricity supplies before commencing any work.**

Check condition and tightness of all cable terminations in control panel.

Remove the fan terminal box cover located on

top of each module (Fig.1), and repeat above procedure for the fan cable terminations.

Check that the plug/socket connection to each fan (inside the unit) is tight and that the cable is in good condition. Switch control panel on and check air curtain for correct operation in each selector switch position (auto/off/man, low/medium/high speed door open/closed).

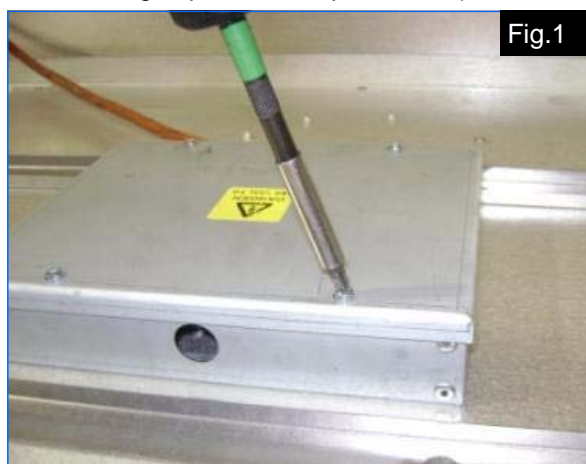

Fig.1

An AmbiRad Group brand



AmbiRad Limited Fens Pool Avenue  
Brierley Hill West Midlands DY5 1QA  
United Kingdom.

Telephone 01384 489700  
Facsimile 01384 489707  
Email marketing@airbloc.co.uk  
Website www.airbloc.co.uk  
Technical Support www.s-i-d.co.uk

**AIRBLOC**  
ENERGY SAVING AIR CURTAINS

Airbloc is a registered trademark of AmbiRad Limited. Because of continuous product innovation, AmbiRad reserve the right to change product specification without due notice.